

- ⊕ Loctite 222
- Loctite 243
- ⊗ Loctite 270

35/38	*	12Nm
35/29	↷	20Nm
⊕ 39/15	↷	60Nm
⊕ 28/15	↷	60Nm
49/43	↷	35Nm
⊗ 45/48-53	↷	11Nm
41/23-38	↷	12Nm
● 16/23-29	↷	2Nm
● 1/15	↷	20Nm

⤵ Tightening direction  
 Sens de serrage  
 Sentido de apriete  
 Anziehrichtung  
 Senso di serraggio  
 Sentido de aperto  
 Kiristysyysuunta  
 Atdragningsriktning  
 Tilstrammingsretning  
 Tilspændingsretning  
 Schroefrichting  
 Φορά σύσφιξης

	(mm)
H maxi	6.6
H mini	5.8

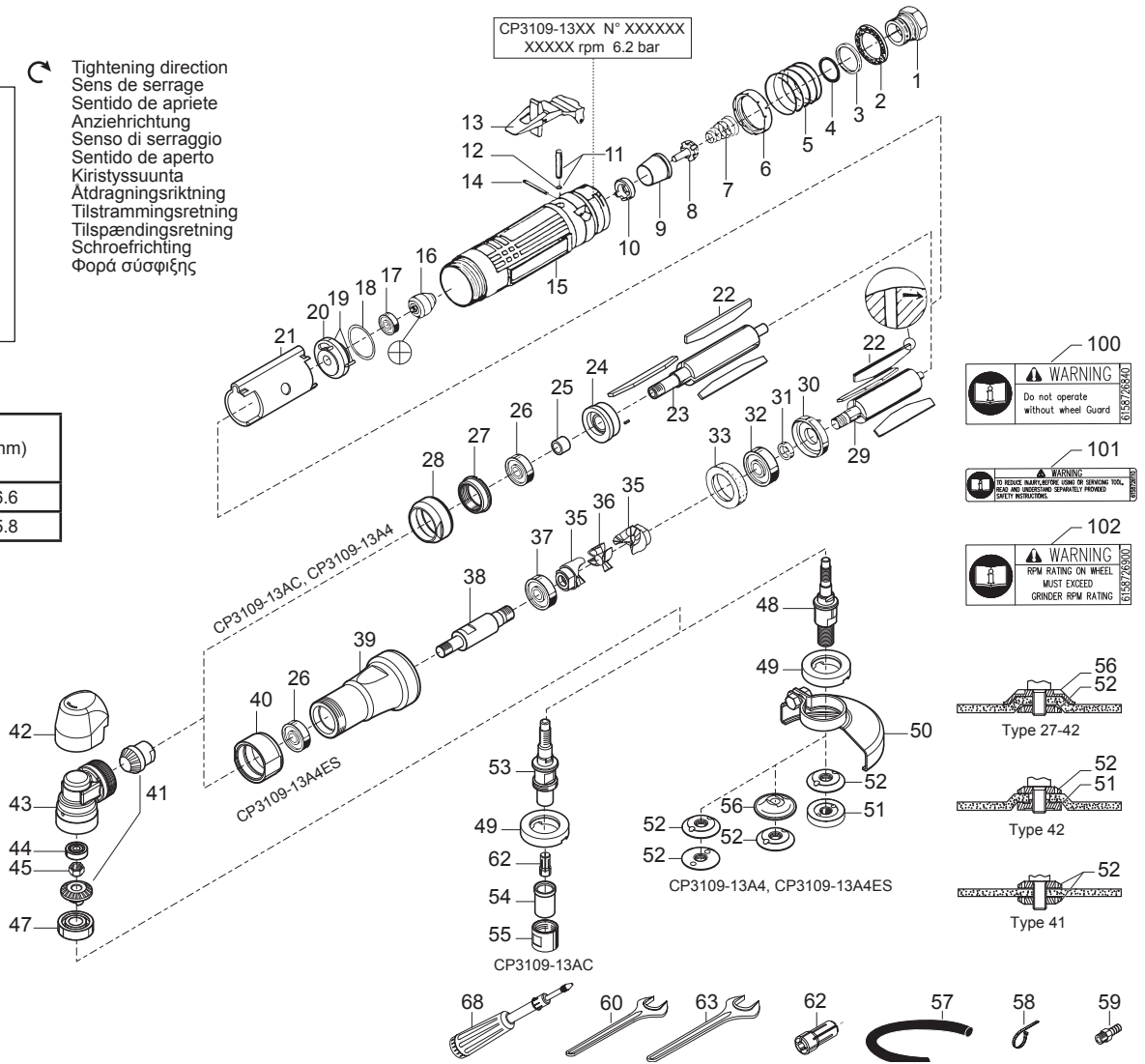

Item	Part No	Description	Qty
<b>A</b>	2050541273	AIR INLET KIT CP3109-... & CP3119-...	
1	-	Adapter 3/8"	1
2	-	Silencer	1
3	-	Spacer	1
4	658.164	O-Ring	1
5	-	Spring	1
6	-	Valve	1
<b>B</b>	2050541283	THROTTLE KIT CP3109-... , CP3119-...	
7	-	Spring-throttle	1
8	-	Throttle	1
9	-	Tube inlet	1
10	-	Seat throttle	1
<b>C</b>	2050541293	LEVER KIT CP3109-... , CP3119-...	
11	-	Pin valve	1
12	-	O-Ring	1
13	-	Safety lever	1
14	-	Roll pin	1
<b>D</b>	2050541553	REAR PLATE KIT	
17	-	Ball bearing	1
18	656.148	Gasket	1
19	-	Roll pin	2
20	-	Rear plate	1
<b>E</b>	2050541653	FRONT PLATE KIT CP3109-13AC & CP3109-13A4	
24	-	Front plate CP3109-13AC & CP3109-13A4	1
25	-	Spacer CP3109-13AC & CP3109-13A4	1
26	-	Ball bearing	1
<b>F</b>	2050541573	FRONT PLATE KIT CP3109-...ES	
30	-	Front plate CP3109-13A4ES	1
31	-	Spacer CP3109-13A4ES	1
32	753.64	Ball bearing CP3109-13A4ES	1

Item	Part No	Description	Qty
<b>G</b>	2050541303	MOTOR KIT CP3109-13AC & CP3109-13A4	
D	2050541553	Rear plate kit	1
E	2050541653	Front plate kit CP3109-13AC & CP3109-13A4	1
21	400.131	Cylinder	1
22	434.53	Blade	3
23	6154260980	Rotor CP3109-13AC & CP3109-13A4	1
<b>H</b>	2050541343	MOTOR KIT CP3109-13A4ES	
D	2050541553	Rear plate kit	1
F	2050541573	Front plate kit CP3109-13A4ES	1
21	400.131	Cylinder	1
22	434.53	Blade	3
29	426.84	Rotor CP3109-13A4ES	1
<b>I</b>	2050541603	COUPLING KIT CP3109-13A4ES	
35	-	Coupling fork	2
36	-	Coupling	1
<b>J</b>	2050541313	BEVEL GEAR KIT	
41	-	Bevel gear	1
44	-	Ball bearing	1
45	-	Nut	1
47	-	Ball bearing	1
<b>K</b>	2050541323	ANGLE HEAD KIT CP3109-13A4 & CP3109-13A4ES	
E	2050541313	Bevel gear kit	1
42	6155704290	Shield	1
43	595.230	Housing angle	1
48	-	Spindle wheel 3/8" CP3109-13A4 & CP3109-13A4ES	1
49	-	Cap-angle housing CP3109-13A4 & CP3109-13A4ES	1

Item	Part No	Description	Qty
<b>L</b>	2050541333	ANGLE HEAD KIT CP3109-13AC	
E	2050541313	Bevel gear kit	1
O	2050541413	Collet clamp kit	1
42	6155704290	Shield	1
43	595.230	Housing angle	1
49	-	Cap-angle housing CP3109-13A4 & CP3109-13A4ES	1
53	2050541433	Spindle-collet CP3109-13AC	1
62	6155260590	Serie 300 resilient collet 1/4"	1
<b>M</b>	2050541633	EXTENSION KIT CP3109-13A4ES	
37	-	Ball bearing CP3109-13A4ES	1
38	-	Shaft CP3109-13A4ES	1
39	-	Housing CP3109-13A4ES	1
40	-	Sleeve CP3109-13A4ES	1
26	-	Ball bearing	1
<b>N</b>	2050541643	PLUG KIT CP3109-13AC, CP3109-13A4	
27	-	Spacer CP3109-13AC, CP3109-13A4	1
28	-	Plug CP3109-13AC, CP3109-13A4	1
<b>O</b>	2050541413	COLLET CLAMP KIT	
54	-	Cap CP3109-13AC	1
55	-	Nut CP3109-13AC	1

Item	Part No	Description	Qty
15	6153962340	Motor housing	1
16	457.19	Governor 24K	1
33	645.132	Spacer CP3109-13A4ES	1
50	6155041600	Wheel guard 4" CP3109-13A4, CP3109-13A4ES	1
51	6156065150	Flange CP3109-13A4 CP3109-13A4ES	1
52	6155020640	Flange CP3109-13A4 CP3109-13A4ES	1
56	6155031440	Rear Flange type 27	1
57	6158726840	Exhaust hose (L=60" - 1,5m)	1
58	6158734150	Hose clamp	1
59	6157040170	Air hose nipple 3/8" for 5/8" ID hose	1
60	6158010030	Flat wrench 7/16"	1
61	6158020080	20-3 mm Pin wrench CP3109-13A4, CP3109-13A4ES	1
62	6155260590	Serie 300 resilient collet 1/4"	1
63	6158010320	Flat wrench CP3109-13AC	1
68	6159901490	Grease gun 0,8 oz. (24g)	1
100	6158726840	Warning guard label	1
101	6158726110	Warning instruction	1
102	6158726900	Warning wheel speed	1

TUNE UP KIT CP3109-13A4ES		
	2050541663	including Part No: 4, 17, 18, 19, 22, 26, 32, 37, 44, 47

TUNE UP KIT CP3109-13 AC/A4		
	2050541673	including Part No: 4, 17, 18, 19, 22, 26, 44, 47

	<b>2050541123</b>	<b>Operator's manual</b>
	<b>6159948750</b>	<b>Safety instructions die-grinder</b>
	<b>6159948760</b>	<b>Safety instructions grinder</b>
	<b>2050541103</b>	<b>EC declaration die-grinder</b>
	<b>2050541213</b>	<b>EC declaration grinder</b>